



# For Lease: Warehouse Space

## 67 Galli Drive, Unit F, Novato, CA

- 16' Clear Ceiling Height
- Great for Storage
- Private Restroom
- End-Cap Unit
- Minutes from Highway 101

Offering Summary	
<b>Total Available sq. ft:</b>	<b>1,087 +/- sf</b>
<b>Initial Base Rent:</b>	<b>\$1.85 psf</b>
<b>Lease Type:</b>	<b>Ind. Gross</b>
<b>Lease Term:</b>	<b>3-5 Years</b>
<b>Available:</b>	<b>Now</b>



**Joe Morrison**  
 (415) 366-0022  
[joe@hlcre.com](mailto:joe@hlcre.com)  
 Lic#: 02067309

**HL Commercial Real Estate**  
[www.hlcre.com](http://www.hlcre.com)



# For Lease: Warehouse Space

67 Galli Drive, Unit F, Novato, CA 94949

## Building/Space Description:

---

Unit F offers a flex-industrial layout ideal for warehouse, light industrial, contractor, distribution, and storage users. The unit includes a warehouse area with one grade-level roll-up door, a private office, private restroom, and storage above the office. Additional features include approximately 16-foot clear ceiling height, 100-amp electrical service, a monitored fire sprinkler system, and a dedicated personnel entrance separate from the warehouse roll-up door. The suite is located within a multi-unit light industrial building with shared on-site parking, plus additional street parking available along Galli Drive.

## Location Description:

---

67 Galli Drive is conveniently located in Novato's established industrial area, minutes from Highway 101 and Downtown Novato. The surrounding area is home to a variety of contractors, service providers, light industrial users, and local businesses. Its central location provides easy access throughout Marin, Sonoma, and San Francisco counties, making it well-suited for businesses with customers, employees, or operations throughout the region. Nearby restaurants, retail services, banking, and other everyday amenities add to the convenience of the location.

## Space Information/Features:

---

Total Available Square Feet:	1,087 +/- sq. ft.
Divisible/Can Add:	No
Ceiling Clear Height:	16 Feet
Power Available at Sub-Panel:	100 Amp
Parking:	11 spaces onsite
Number of Roll-up Doors:	One

## Building Information/Features:

---

Total Building Square Feet:	6,772 +/- sq. ft.
Year Constructed:	1980+/-
Zoning/Permitted Uses:	<a href="#">Planned District (PD)</a>
Fire Sprinklers:	Yes
Heating & Air Conditioning:	No
Flood Zone Designation:	Zone X (500-year)

An area inundated by 500-year flooding; an area inundated by 100-year flooding with average depths of less than 1 foot or with drainage area less than 1 square mile; or an area protected by levees from 100-year flooding.

## Lease Information:

---

Lease Term:	3-5 Years
Initial Base Rent:	\$1.85/psf, plus 3% annual increases
Lease Type:	Industrial Gross
Tenant Expenses:	Gas, electricity, interior janitorial, trash, \$15/mo for water. Increases over base year RE Taxes

# For Lease: Warehouse Space

67 Galli Drive, Unit F, Novato, CA 94949

GALLI DRIVE

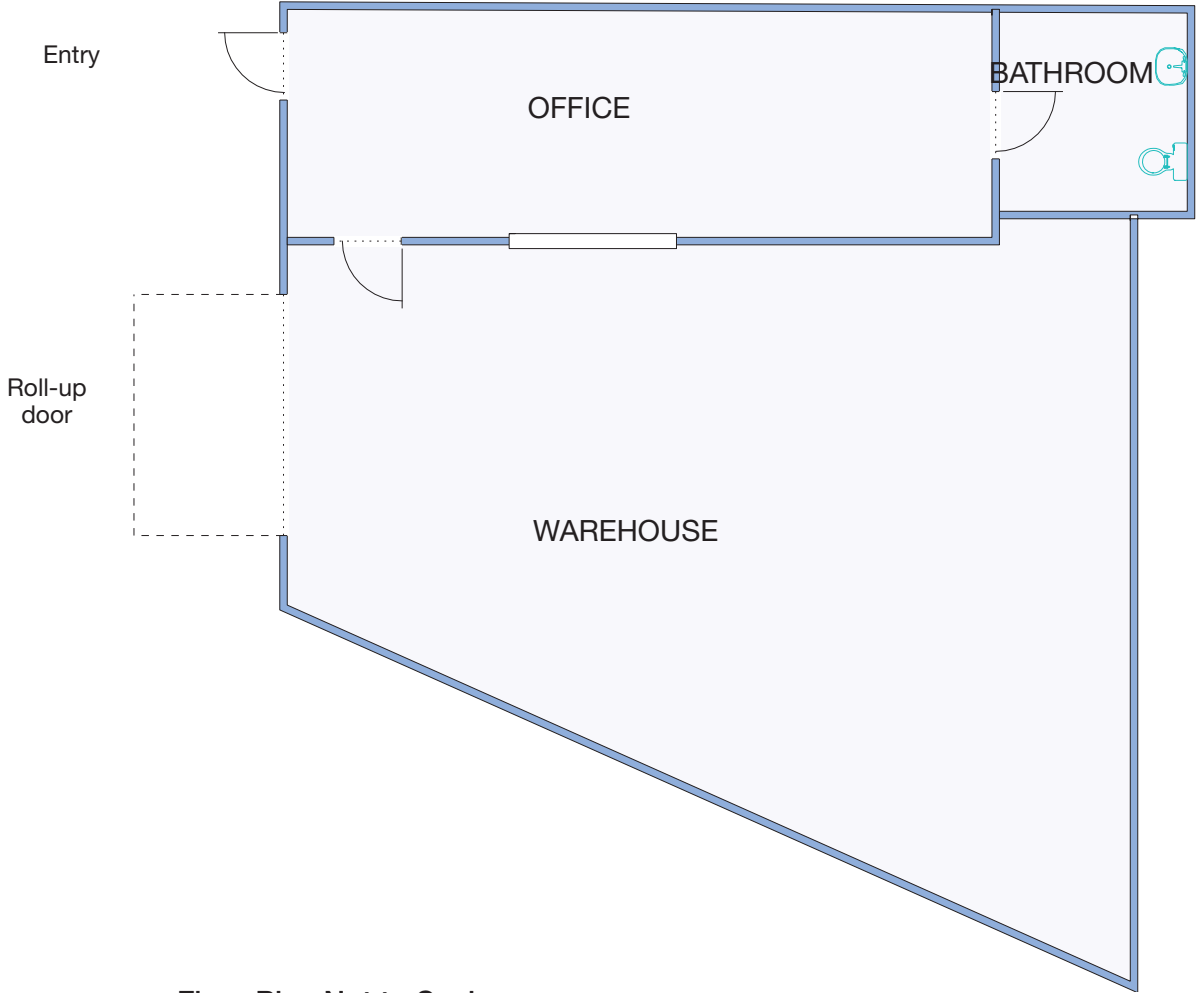

Floor Plan Not to Scale  
For Illustration Only



**Joe Morrison**  
(415) 366-0022  
[joe@hlcre.com](mailto:joe@hlcre.com)  
Lic#: 02067309

**HL Commercial Real Estate**  
[www.hlcre.com](http://www.hlcre.com)



No warranty or representation, express or implied, is made as to the accuracy of the information contained herein, and same is submitted subject to errors, omissions, change of price, rental or other conditions, withdrawal without notice, and to any special listing conditions imposed by our principals. The prospective purchaser/lessee should independently verify all information.

# For Lease: Warehouse Space

67 Galli Drive, Unit F, Novato, CA 94949

GALLI DRIVE

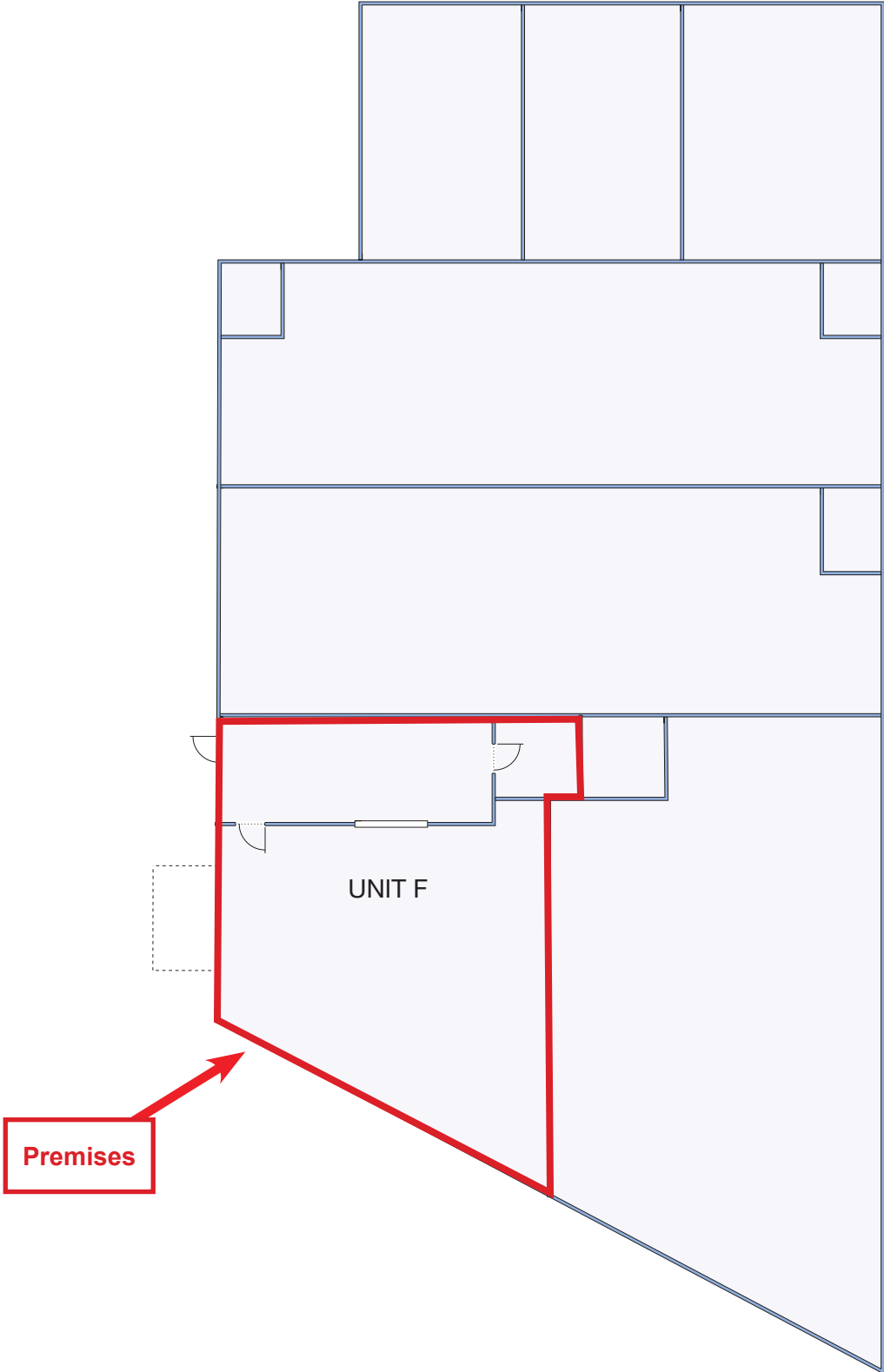

# For Lease: Warehouse Space

67 Galli Drive, Unit F, Novato, CA 94949



[Click here to View in Google Maps](#)

# Our Company



HL Commercial Real Estate (HLCRE) was founded in 1980 and is a full-service commercial brokerage and property management firm based in San Rafael, California. For more than four decades, HLCRE has been a trusted advisor to investors, business owners, and property developers throughout Marin County and the greater Bay Area. The firm's expertise spans office, retail, industrial, multifamily, mixed-use, and land transactions, representing clients in sales, leasing, and investment acquisitions.



With more than \$3.8 billion in completed transactions, HLCRE combines deep local knowledge with a sophisticated understanding of regional and statewide markets. The team's approach is built on integrity, insight, and long-term relationships—ensuring every client receives thoughtful advice and diligent execution.

- Sales
- Leases
- Seller/Landlord Representation
- Buyer/Tenant Representation
- Property Management
- Tax Deferred Exchanges

For clients seeking experience, professionalism, and a personalized approach to commercial real estate, HL Commercial Real Estate offers a proven record of performance and partnership. For a free evaluation or service description, please contact us.

## Higher Level Commercial Real Estate

70 Mitchell Blvd., Ste. 202  
San Rafael, CA 94903  
[www.hlcre.com](http://www.hlcre.com)



**Joe Morrison**  
(415) 366-0022  
[joe@hlcre.com](mailto:joe@hlcre.com)  
Lic#: 02067309